

MODERN ENGINEERING WORKS

AN ISO 9001 - 2008 Certified Organization



FLEXIBLE PIN BUSH COUPLING



FLEXIBLE PIN BUSH COUPLING

Introduction

Flexible Pin Bush Couplings are in use in general industrial applications over many years and are quite useful in drives where limited misalignment of shafts is unavoidable.

Flexible Pin Bush Coupling comprises two Hubs in Cast Iron of high quality and variable number of flexible elements, depending on the power to be transmitted. The flexible elements of rubber bushes are capable of damping vibration and shock loads as well as accepting misalignment that inevitably occurs between rotating shafts which are independently supported.

Flexible Pin Bush Coupling is suitable for rotation in either direction and does not require lubrication. Irgation Rubber used for manufacture of bushes is of high quality and works as a safeguard against any bad effect of water, dust and atmospheric conditions.

Selection

Select the Flexible Pin Bush Coupling of size that will accommodate the diameter of the larger shaft of a drive. To ensure above Coupling so selected has the required rating capacity:

- Check the Service Factor applicable to the drive from the Service Factor Chart.
- Find out the rating HP/RPM of the drive as per the following formula:

$$\frac{\text{HP} \times \text{Service Factor}}{\text{RPM}} = \text{HP/RPM}$$

- Check that the rating: HP/RPM of the selected coupling is either to, or, greater than the calculated rating as above.

Fig - 1 (MPB 10 - MPB 60) Type - A

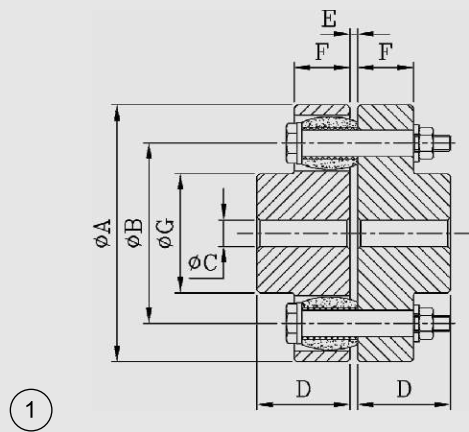

Fig - 2 (MPB 70 - MPB 200) Type - B

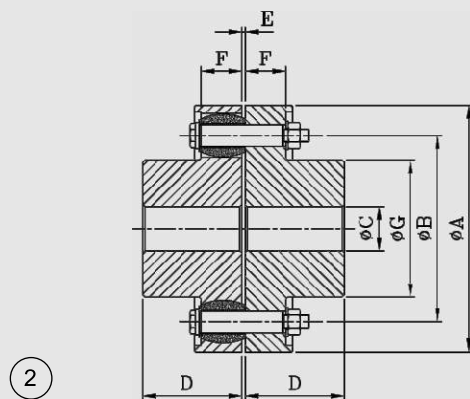
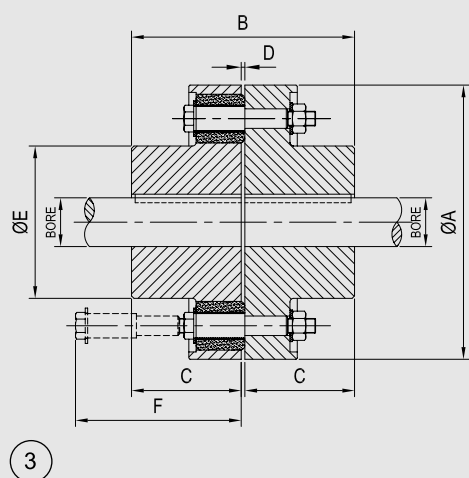

Fig - 3 Type V





Type A & B Rating and Dimensions in mm (approx)

Size	Rating		GD ² Kg M ²	Safe Speed RPM	Approx Wt Kg	Pilot	Max	No. of Pins	Dimensions in mm					
	Torque Kg M	HP/RPM							A	B	D	E	F	G
MPB 10	4.30	0.006	0.0064	5000	1.70	10	30	4	98	68	36	3	21	45
MPB 20	15.04	0.021	0.0140	4500	3.10	10	35	8	113	84	46	3	24	58
MPB 30	22.92	0.032	0.0260	4000	4.40	10	40	8	131	95	51	3	25	68
MPB 40	37.95	0.053	0.0440	3800	5.50	15	45	8	141	100	51	3	25	72
MPB 50	50.12	0.070	0.0800	3600	8.60	20	55	8	161	116	61	2	28	82
MPB 60	85.92	0.120	0.1450	3000	15.10	20	75	10	191	145	76	2	28	110
MPB 70	143.20	0.200	0.4800	2650	25.00	40	90	10	226	170	91	3	37	125
MPB 80	300.72	0.420	0.7600	2300	31.00	50	100	10	251	180	91	3	40	132
MPB 90	322.20	0.450	2.000	2000	60.00	50	110	10	301	230	121	3	45	176
MPB 100	479.72	0.670	3.5600	1800	86.50	60	125	10	341	260	141	3	55	192
MPB 110	716.00	1.000	6.4900	1650	118.20	70	140	10	381	295	161	3	55	220
MPB 120	930.80	1.300	8.4850	1600	135.30	70	150	10	411	325	161	3	60	251
MPB 130	1074.00	1.500	13.8200	1500	173.40	80	160	8	441	335	171	4	70	255
MPB 140	1575.00	2.200	24.8050	1250	261.00	90	180	10	501	390	201	4	70	308
MPB 150	2434.40	3.400	48.3200	1120	391.00	90	200	10	561	425	221	4	85	321
MPB 160	4317.48	6.030	76.8300	1050	516.00	90	200	10	631	480	241	5	95	364
MPB 170	4976.20	6.950	120.320	950	572.00	125	225	12	711	560	261	5	100	439
MPB 180	5370.00	7.500	156.480	850	668.00	125	250	12	751	585	281	5	102	456
MPB 190	9809.20	13.700	195.965	800	758.00	150	300	16	801	630	291	5	110	494
MPB 200	15036.00	21.000	302.345	750	983.00	175	325	16	901	730	311	5	125	589

Flexible Couplings Type N

Size	No. Of Pins	Torque KgM	Stock Min Bore	Max. Bore	Max. Speed in rev/min	A	B	C	D	E	F	Approx Wt Kg
MPB 10N	3	7.70	12.7	28	6100	96	80	39	3	40	58	2.0
MPB 20N	4	31.00	12.7	30	5100	114	98	48	3	42	70	3.5
MPB 30N	6	51.60	16	42	4400	131	106	52	3	60	70	5.0
MPB 40N	4	62.10	16	48	3600	160	108	52	5	68	114	11.00
MPB 50N	4	83.10	20	65	3000	192	124	60	5	90	114	21.00
MPB 50AN	6	124.10	20	65	3000	192	124	60	5	90	114	22.00
MPB 60N	6	166.20	25	75	2600	225	156	76	5	105	114	30.00
MPB 60N	8	235.90	45	95	2300	255	184	90	5	135	114	39.00
MPB 60AN	10	293.20	45	95	2300	255	184	90	5	135	114	41.00
MPB 60BN	12	353.30	45	95	2300	255	184	90	5	135	114	43.00
MPB 70	12	415.40	60	115	1950	290	234	115	5	170	114	70.00
MPB 80	14	519.50	60	120	1900	301	234	115	5	180	130	78.00
MPB 90	16	581.60	65	130	1850	310	256	126	5	195	130	90.00
MPB 100	18	726.80	65	135	1650	341	264	130	5	200	130	98.00
MPB 110	12	872.90	70	140	1590	360	227	136	6	210	200	130.00
MPB 120	13	993.20	80	150	1470	391	315	155	6	225	200	50.00
MPB 130	15	1327.40	90	160	1400	410	337	166	6	240	200	160.00
MPB 140	16	1442.00	100	170	1300	441	365	180	6	255	200	175.00
MPB 150	17	1805.00	110	180	1200	480	387	191	6	270	212	225.00
MPB 160	20	2378.00	120	190	1080	531	405	200	6	285	212	310.00



OUR OTHER PRODUCT



SHEET METAL PRODUCT



WHEEL & AXLES



GEAR BOX



HOPPER



HEAT EXCHANGER



PRESSURE VESSEL

OUR OTHER PRODUCT



CONVEYOR PULLEY WITH RING FEEDER



SHAFT



ROPE DRUM



NUT & BOLT



IMPELLER CASING



IMPELLER

**OUR OTHER PRODUCT
FOR MATERIAL HANDLING EQUIPMENT
CONVEYOR PULLEY & IDLER**

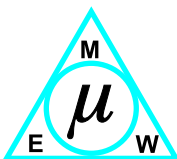

MODERN ENGINEERING WORKS

AN ISO 9001 - 2008 Certified Unit



The Certification Bodies :
TUV SUD South Asia Pvt. Ltd.

OFFICE : Ichapur, Sealdanga, H.I.T. Road
Howrah - 711104, West Bengal (India)
WORKS : Lakshmanpur Industrial Area,
P.O. - Lakshmanpur, Howrah - 711114
West Bengal (India)
Phone : 91- 033 - 2667 - 1406
E-mail : mew.hazra@gmail.com
Website : www.modernengineeringworks.co.in